



1 Brighton Grove, Sale, Greater Manchester, M33 7EZ

****CHAIN FREE****

A delightful three-bedroom, end-terrace home in the heart of sale offering well-proportioned living space, excellent local amenities and a spacious layout across two floors. Perfect for a first-time buyers, young families or investors.

The ground floor offers a seamless flow between living, dining and kitchen area sitting at the rear. Upstairs hosts three well-proportioned bedrooms alongside a contemporary three-piece bathroom suite.

Enjoy a private courtyard at the rear - ideal for al fresco dining or quiet relaxation. Convenient permit parking is available at the front.

Freehold. EPC D. Council Tax Band B.

£285,000

Viewing arrangements

Viewing strictly by appointment through the agent

95-97 School Road, Sale, Cheshire, M33 7XA 0161 962 2828

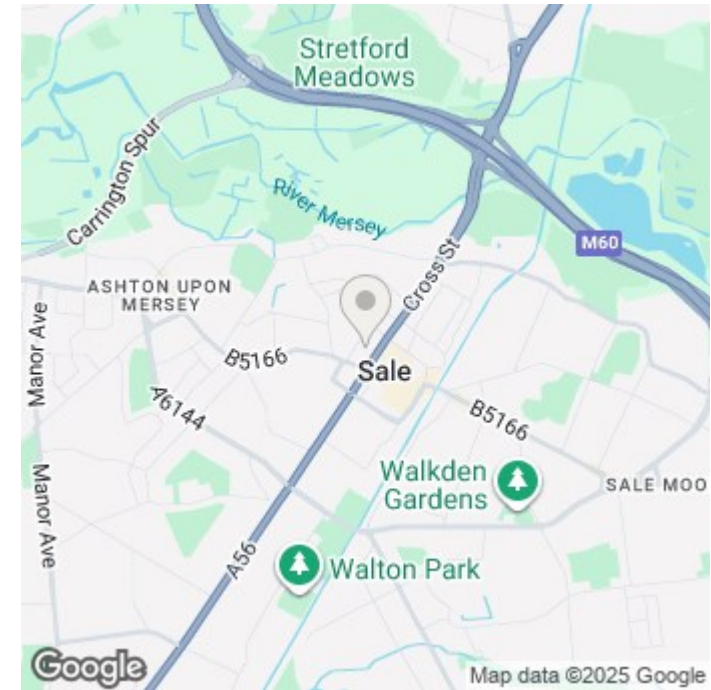

Energy Efficiency Rating		
	Current	Potential
<i>Very energy efficient - lower running costs</i>		
(92 plus) A		
(81-91) B		
(69-80) C		
(55-68) D		
(39-54) E		
(21-38) F		
(1-20) G		
<i>Not energy efficient - higher running costs</i>		
England & Wales	EU Directive 2002/91/EC	

Environmental Impact (CO ₂) Rating		
	Current	Potential
<i>Very environmentally friendly - lower CO2 emissions</i>		
(92 plus) A		
(81-91) B		
(69-80) C		
(55-68) D		
(39-54) E		
(21-38) F		
(1-20) G		
<i>Not environmentally friendly - higher CO2 emissions</i>		
England & Wales	EU Directive 2002/91/EC	



GROUND FLOOR
359 sq.ft. (33.3 sq.m.) approx.

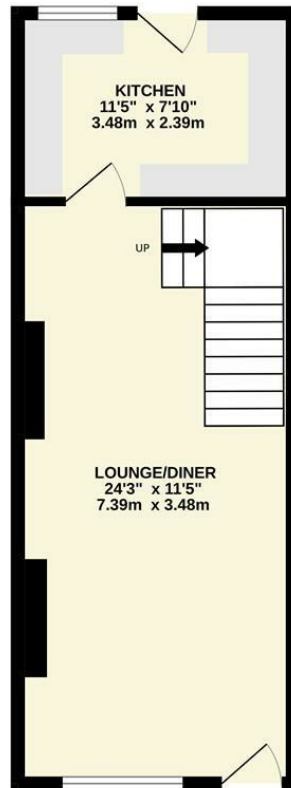

1ST FLOOR
363 sq.ft. (33.7 sq.m.) approx.

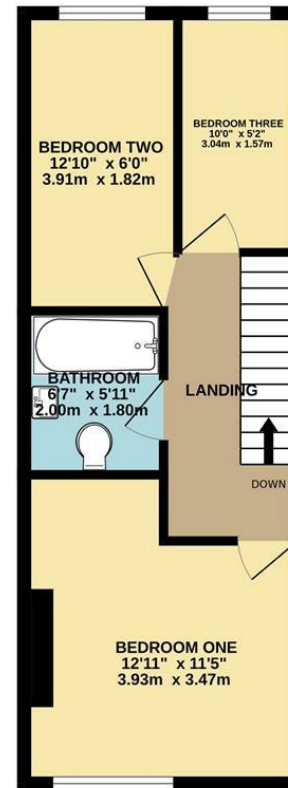

TOTAL FLOOR AREA: 722 sq.ft. (67.0 sq.m.) approx.
Measurements are approximate. Not to scale. Illustrative purposes only.
Made with Metropix ©2025



These particulars are believed to be accurate but they are not guaranteed and do not form a contract. Neither Jordan Fishwick nor the vendor or lessor accept any responsibility in respect of these particulars, which are not intended to be statements or representations of fact and any intending purchaser or lessee must satisfy himself by inspection or otherwise as to the correctness of each of the statements contained in these particulars. Any floorplans on this brochure are for illustrative purposes only and are not necessarily to scale.

Offices at: Chorlton, Didsbury, Disley, Hale, Glossop, Macclesfield, Manchester Deansgate, Manchester Whitworth Street, New Mills, Sale, Wilmslow and Withington

95-97 School Road, Sale, Cheshire, M33 7XA

0161 962 2828

sale@jordanfishwick.co.uk
www.jordanfishwick.co.uk

